

**E1** ABATEMENT PLAN - BLDG # 200  
 3/32"=1'-0" 13,766 BUILDING SF.

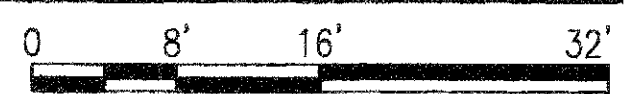

**GENERAL NOTES - ENVIRONMENTAL BUILDING #200**

- A. CONTRACTOR SHALL REMOVE AND DISPOSE OF REGULATED ASBESTOS-CONTAINING MATERIAL TSI AS CLASS I ASBESTOS WORK, IN COMPLIANCE WITH 29 CFR 1926.1101 (OSHA WORKER PROTECTION), 40 CFR PART 61 SUBPART M (ASBESTOS NESHAP), AND PER TECHNICAL SPECIFICATIONS SECTION 13280 - ASBESTOS ABATEMENT ACTIVITIES.
- B. CONTRACTOR SHALL REMOVE AND DISPOSE OF CATEGORY I AND CATEGORY II NONFRIABLE ASBESTOS-CONTAINING MATERIALS (ACMs) AS CLASS II ASBESTOS WORK PER TECHNICAL SPECIFICATIONS SECTION 13280 - ASBESTOS ABATEMENT ACTIVITIES.
- C. CONTRACTOR SHALL DEMOLISH, REMOVE AND DISPOSE OF BUILDING COMPONENTS COATED WITH LEAD-BASED PAINTS (LBP<sub>s</sub>) IN COMPLIANCE WITH 29 CFR 1926.62 (OSHA WORKER PROTECTION) AND PER TECHNICAL SPECIFICATIONS, SECTION 13281 - LEAD HAZARD CONTROL ACTIVITIES.
- D. CONTRACTOR SHALL DEMOLISH, REMOVE AND DISPOSE OF LEAD-CONTAINING MATERIALS (LCM<sub>s</sub>) IN COMPLIANCE WITH 29 CFR 1926.62 (OSHA WORKER PROTECTION) AND PER TECHNICAL SPECIFICATIONS, SECTION 13281 - LEAD HAZARD CONTROL ACTIVITIES.
- E. CONTRACTOR SHALL REMOVE AND DISPOSE OF PCB-CONTAINING BALLASTS FROM FLUORESCENT LIGHT FIXTURES PER APPLICABLE FEDERAL, STATE AND LOCAL REGULATIONS.

**KEY NOTES - ENVIRONMENTAL BUILDING #200**

1. REMOVE GLUED-DOWN CARPETING FROM CATEGORY I FLOOR TILES OR MASTIC ON CONCRETE SLAB; DISPOSE OF AS ASBESTOS-CONTAMINATED MATERIAL; CLASS III ASBESTOS WORK.
2. REMOVE CATEGORY I FLOOR TILES AND/OR MASTIC FROM CONCRETE SLAB; CLASS II ASBESTOS WORK.
3. REMOVE TSI FROM ELBOWS/FITTINGS ON FIBROUS GLASS-INSULATED PIPING IN MECHANICAL ROOM AND IN CRAWLSPACE; CLASS I ASBESTOS WORK.
4. REMOVE LINOLEUM SHEETGOODS FROM CONCRETE FLOOR; CLASS II ASBESTOS WORK.
5. REMOVE INSULATION ON BOILER FLUE; CLASS II ASBESTOS WORK.
6. REMOVE AND DISPOSE OF BOILER(S) INTACT, WITH TSI MUD INSIDE; CLASS III ASBESTOS WORK.
7. REMOVE ACBM FIRE DOORS; CLASS IV ASBESTOS WORK.

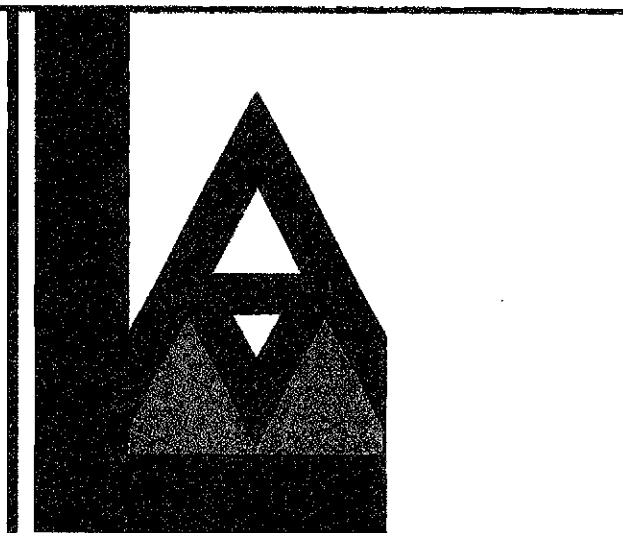
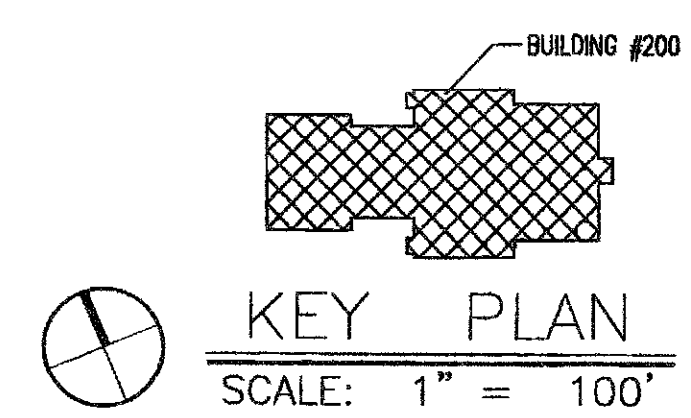
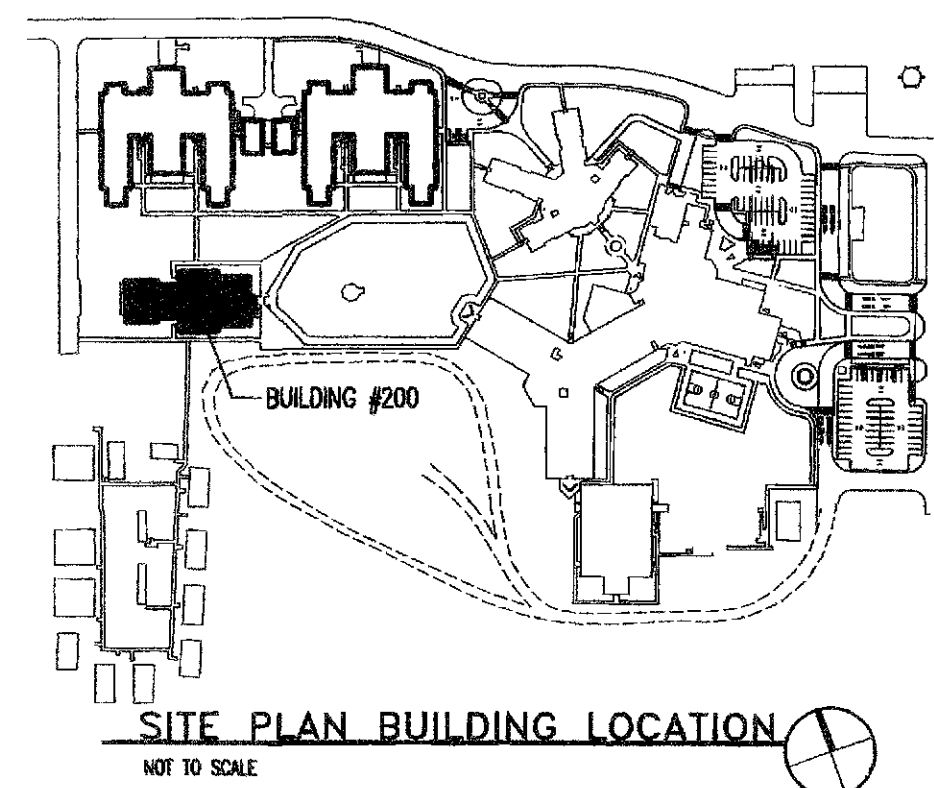

LAM Corporation  
 317 Bortot Drive  
 Gallup, NM 87301-4779  
 505.722.0965 fax 505.722.2057  
 E-Mail: lorenmiller@lamcorporation.com

**STUDIO**  
**SW**  
**ARCHITECTS**

STUDIO SOUTHWEST ARCHITECTS, INC.  
 2101 Mountain Rd. NW, Albuquerque, NM 87104  
 505.843.9639 fax 505.843.9663  
 Web Site: www.studioswarch.com  
 E-Mail: mail@studioswarch.com

© 2006, Studio Southwest Architects, Inc. Reproduction or reproduction by any means without the express written consent of Studio Southwest Architects, Inc. is a violation of Federal and International law. The information contained on this document is the intellectual property of Studio Southwest, Inc. and all rights therein are reserved. For exceptions, refer to the Owner-Architect Agreement.

**CONSULTANTS**  
 Tom Shishman, REM  
 SHISHMAN & ASSOCIATES INC.  
 6501 Wyoming Boulevard NE, Ste. C-130  
 Albuquerque, NM 87109  
 Tel. 505.237.9800  
 Fax 505.797.1272

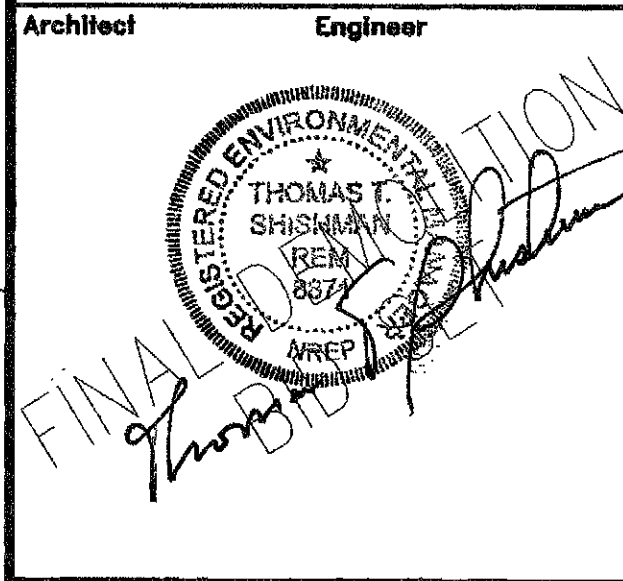

**DILCON COMMUNITY SCHOOL**

**DEMO PHASE II**  
 DILCON, AZ

MARK	DATE	DESCRIPTION

ISSUE:  
 PROJECT NO: 0901DD  
 CAD DWG FILE:  
 DRAWN BY:  
 CHECKED BY:  
 DATE: 06-12-09

SHEET TITLE  
 ABATEMENT PLAN  
 BUILDING 200  
 ENV-200