

E4 ABATEMENT PLAN - BLDG # 100 & LOFT
 3/32"=1'-0" 16,297 BUILDING S.F.



GENERAL NOTES - ENVIRONMENTAL BUILDING #100

- CONTRACTOR SHALL REMOVE AND DISPOSE OF REGULATED ASBESTOS-CONTAINING MATERIAL TSI AS CLASS I ASBESTOS WORK, IN COMPLIANCE WITH 29 CFR 1926.1101 (OSHA WORKER PROTECTION), 40 CFR PART 61 SUBPART M (ASBESTOS NESHAP), AND PER TECHNICAL SPECIFICATIONS SECTION 13280 - ASBESTOS ABATEMENT ACTIVITIES.
- CONTRACTOR SHALL REMOVE AND DISPOSE OF CATEGORY I AND CATEGORY II NONFRIABLE ASBESTOS-CONTAINING MATERIALS (ACMs) AS CLASS II ASBESTOS WORK PER TECHNICAL SPECIFICATIONS SECTION 13280 - ASBESTOS ABATEMENT ACTIVITIES.
- CONTRACTOR SHALL DEMOLISH, REMOVE AND DISPOSE OF BUILDING COMPONENTS COATED WITH LEAD-BASED PAINTS (LBPs) IN COMPLIANCE WITH 29 CFR 1926.62 (OSHA WORKER PROTECTION) AND PER TECHNICAL SPECIFICATIONS, SECTION 13281 - LEAD HAZARD CONTROL ACTIVITIES.
- CONTRACTOR SHALL DEMOLISH, REMOVE AND DISPOSE OF LEAD-CONTAINING MATERIALS (LCMs) IN COMPLIANCE WITH 29 CFR 1926.62 (OSHA WORKER PROTECTION) AND PER TECHNICAL SPECIFICATIONS, SECTION 13281 - LEAD HAZARD CONTROL ACTIVITIES.
- CONTRACTOR SHALL REMOVE AND DISPOSE OF PCB-CONTAINING BALLASTS FROM FLUORESCENT LIGHT FIXTURES PER APPLICABLE FEDERAL, STATE AND LOCAL REGULATIONS.

KEY NOTES - ENVIRONMENTAL BUILDING #100

- REMOVE GLUED-DOWN CARPETING FROM CATEGORY I FLOOR TILES OR MASTIC ON CONCRETE SLAB; DISPOSE OF AS ASBESTOS-CONTAMINATED MATERIAL; CLASS III ASBESTOS WORK.
- REMOVE CATEGORY I FLOOR TILES AND/OR MASTIC FROM CONCRETE SLAB; CLASS II ASBESTOS WORK.
- REMOVE TSI FROM ELBOWS/FITTINGS ON FIBROUS GLASS-INSULATED PIPING IN MECHANICAL ROOM AND IN CRAWLSPACE; CLASS I ASBESTOS WORK.
- REMOVE TSI FROM PIPE RUNS; CLASS I ASBESTOS WORK.
- REMOVE INSULATION ON BOILER FLUE; CLASS II ASBESTOS WORK.
- REMOVE AND DISPOSE OF BOILER(S) INTACT, WITH TSI MUD INSIDE; CLASS III ASBESTOS WORK.
- REMOVE ACM FIRE DOORS; CLASS IV ASBESTOS WORK.

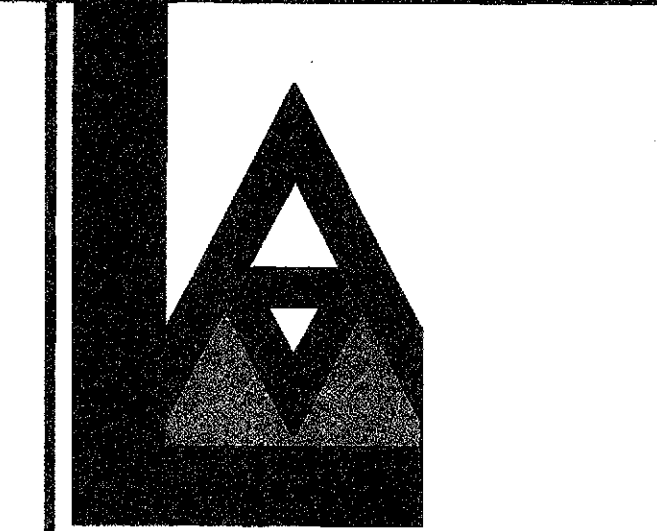
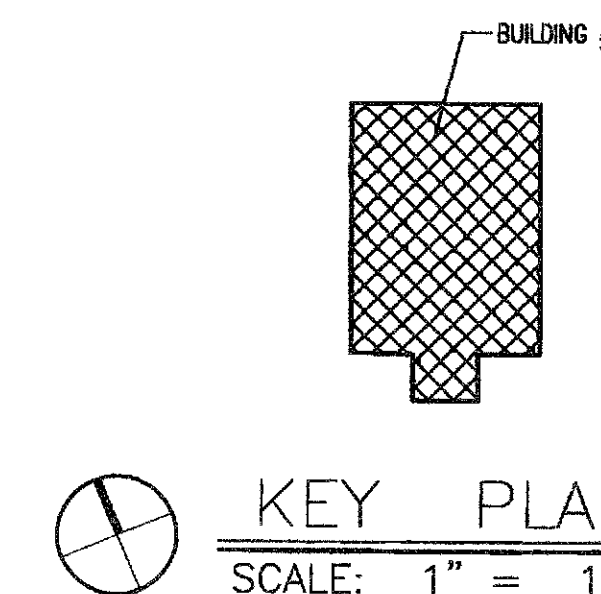
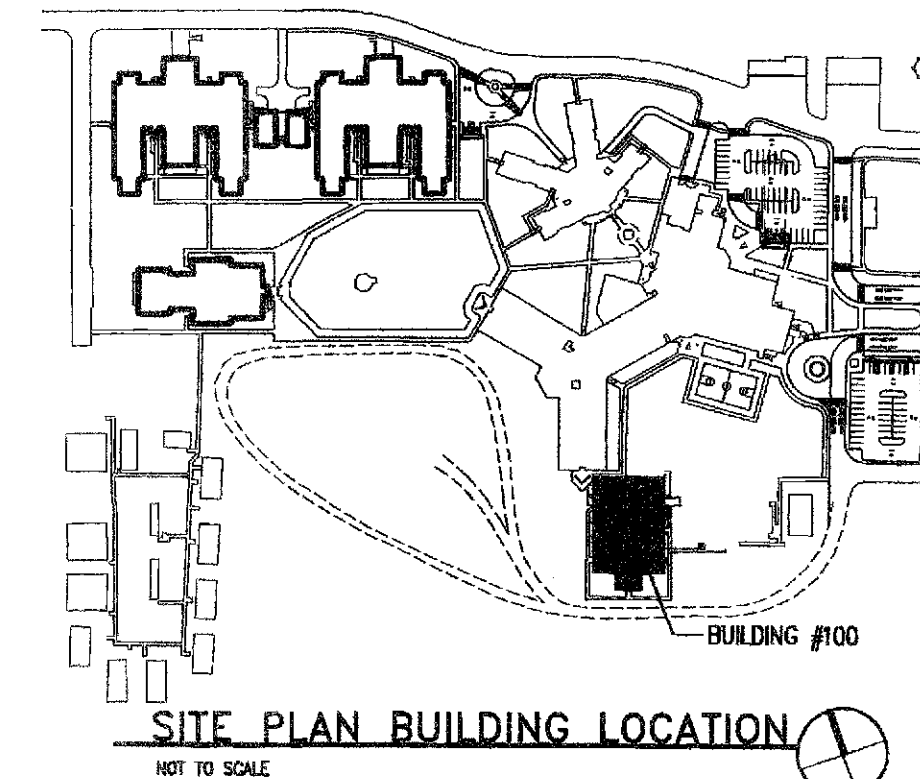

LAM Corporation
 317 Bortot Drive
 Gallup, NM 87301-4779
 505.722.0965 fax 505.722.2057
 E-Mail: loiemiller@lamcorporation.com

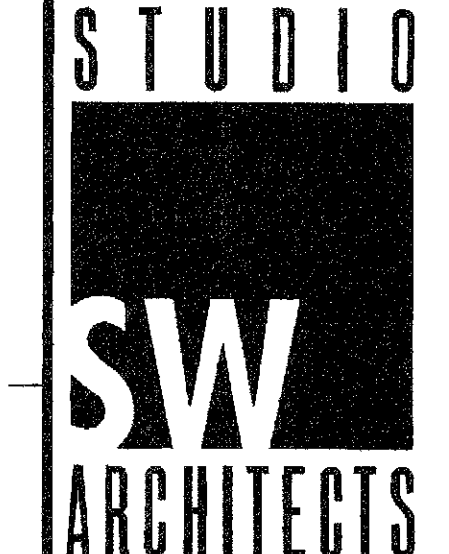

STUDIO SOUTHWEST ARCHITECTS, INC.
 2101 Mountain Rd. NW, Albuquerque, NM 87104
 505.843.9839 fax 505.843.9883
 Web Site: www.studioswarch.com
 E-Mail: mail@studioswarch.com

©2008 Studio Southwest Architects, Inc. All rights reserved. Reproduction or translation in any manner without the express written consent of Studio Southwest Architects, Inc. is a violation of Federal and International Law. The information contained on this document is the intellectual property of Studio Southwest, Inc. and all rights therein are reserved. For questions, refer to the Owner-Architect Agreement.

CONSULTANTS

Tom Shishman, REM
 SHISHMAN & ASSOCIATES INC.
 6501 Wyoming Boulevard NE, Ste. C-130
 Albuquerque, NM 87109
 Tel. 505.237.9800
 Fax 505.797.1272

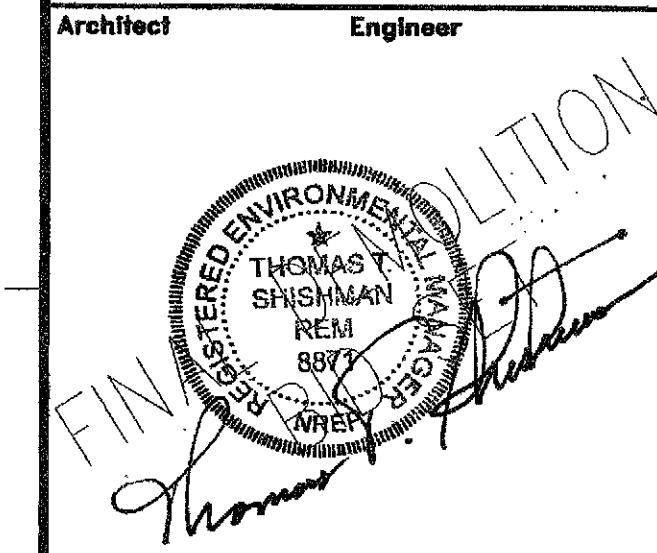

DILCON COMMUNITY SCHOOL

DEMO PHASE II
DILCON, AZ

MARK	DATE	DESCRIPTION

ISSUE:
 PROJECT NO: 0901DD
 CAD DWG FILE:
 DRAWN BY:
 CHECKED BY:
 DATE: 06-12-09

SHEET TITLE
ABATEMENT PLAN
BUILDING 100

ENV-203